

Upstairs

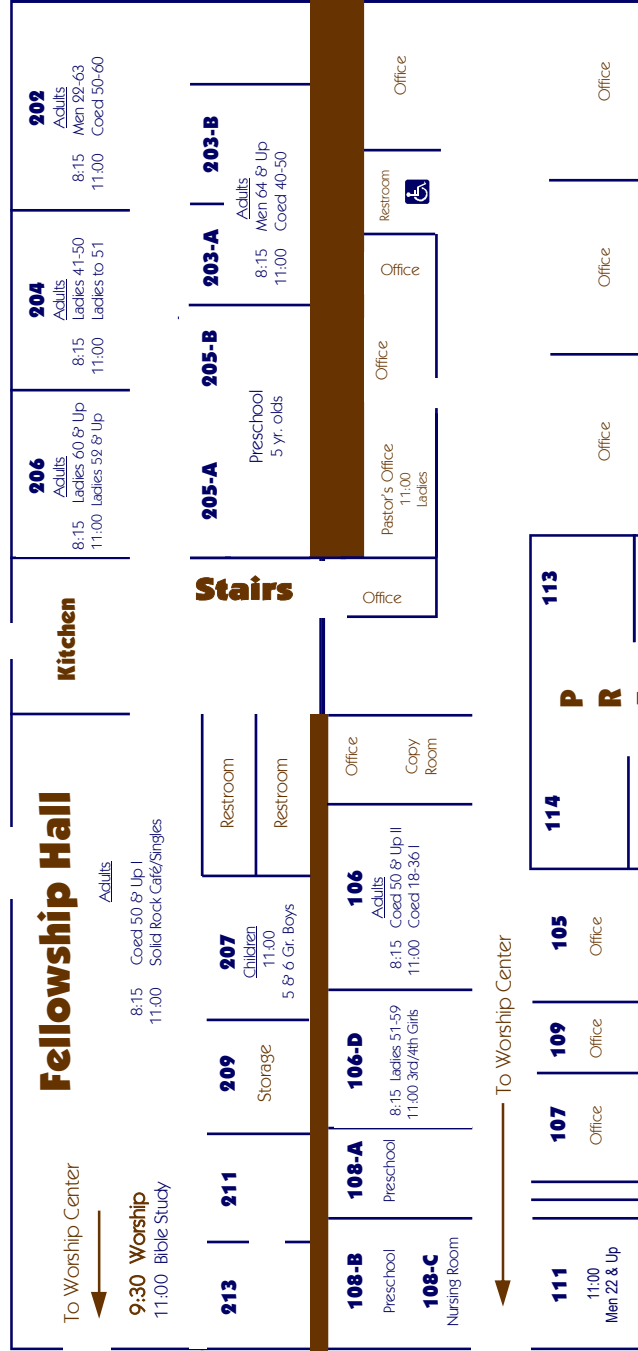

Office Entrance

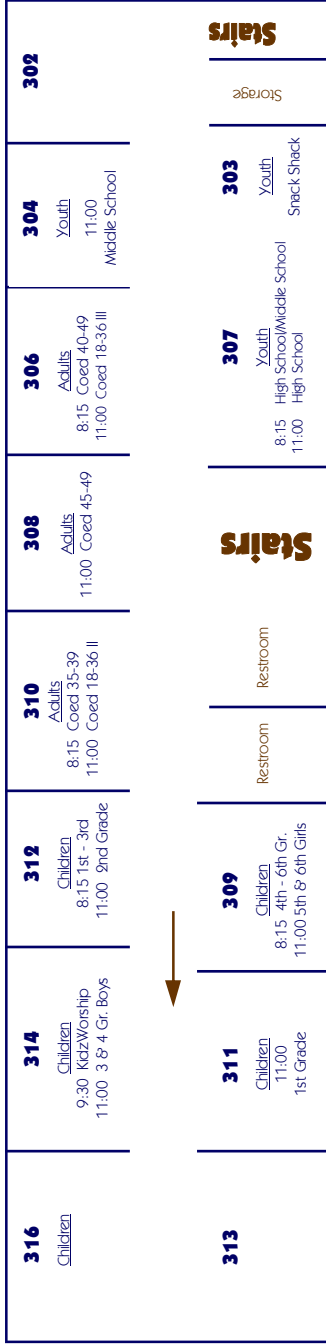
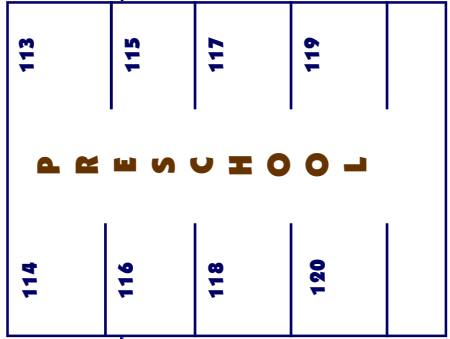

Schedule of Classes & Locations

Adults

Ladies

8:15 AM
 41-50 (A. Kumm).....204
 51-59 (J. Doleman) 106-D
 60 & Up (S. Maroulis)206

11:00 AM
 Ladies (B. Gantt) Pastor's Office
 Ladies to 51 (S. Piland)204
 Ladies 52 & Up (S. Packard)206

Men

8:15 AM
 22-63 (D. Thompson).....202
 64 & Up (N. Powell)203

11:00 AM
 22 & Up (H. Gutelius)111

Coed

8:15 AM
 35-39 (D. Doleman)310
 40-49 I (J. Waters)306

8:15 AM (continued)

50 & Up I (D. Carraway) Fellowship Hall
 50 & Up II (B. Stokes) 106

11:00 AM

18-36 I (B. Peed) 106
 18-36 II (T. Gunsalus)310
 18-36 III (G. Bolen)306
 40-50 (D. Coley)203
 45-49 (D. Hobbs).....308
 50-60 (B. Hobbs)202
 Solid Rock Café (F. Worrell) Fellowship Hall
 Bible Study (D. David) Worship Center
 Career Singles (P. Smith) Fellowship Hall

Youth

8:15 AM

High School Refuge307
 Middle School Refuge307

11:00 AM

Middle School Refuge304
 High School Refuge307

Children

8:15 AM

1st - 3rd Grade312
 4th - 6th Grade (B. & N. Schimming).....309

9:30 AM

KidzWorship (Gr. 1-4)314

11:00 AM

1st Grade (L. & A. Crowder)311
 2nd Grade (T. Elmore/M. Jensen)312
 3 & 4 Gr. Girls (F. Amick/S. Rowe) ... 106-D
 3 & 4 Gr. Boys (K. Hirlinger/G. Johnson)314
 5 & 6 Gr. Girls (D. Hobbs)309
 5 & 6 Gr. Boys (G. Colantuono/R. Martin)313

Preschool

8:15 AM

Preschool Sunday School

9:30 AM

Extended Session & Wee Worship

11:00 AM

Preschool Sunday School

